

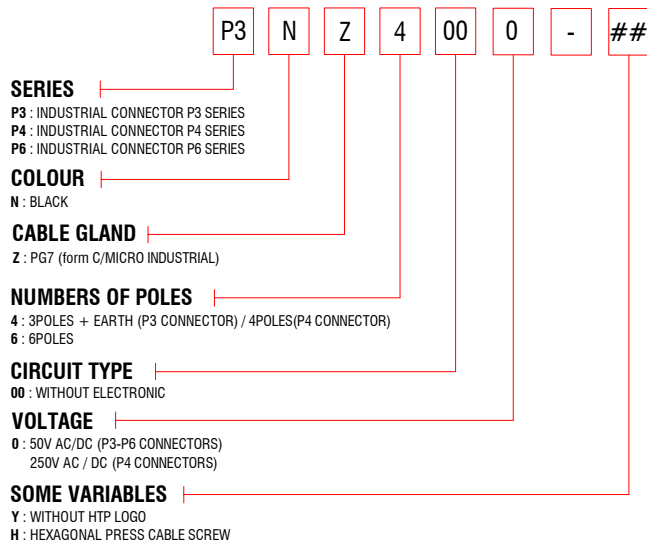

INDUSTRIAL CONNECTORS

GENERAL FEATURES FIELD ATTACHABLE CONNECTORS:

Cable Gland : PG7 : \varnothing CABLE 4 - 6mm	Type of terminations : Solder wires.	Internal core material : PA66 UL94-V2
Conductor cross section : 0.14(26AWG)...0.50mm ² (20AWG).	Contact material and treatment : Brass + tin plated.	Operating temperature : -40°C +90°C
Max. screw torque IEC60947-1 (Central fixing screw) : Max. 0.5 N * m.	Housing material : PA66 UL94-V2	Protection class : IP 65 (assembled).

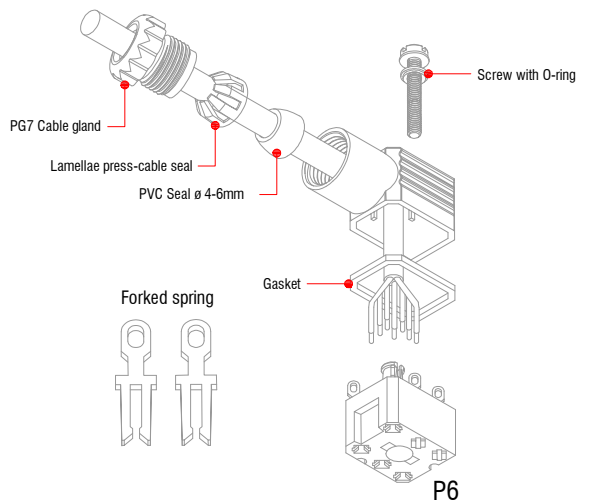
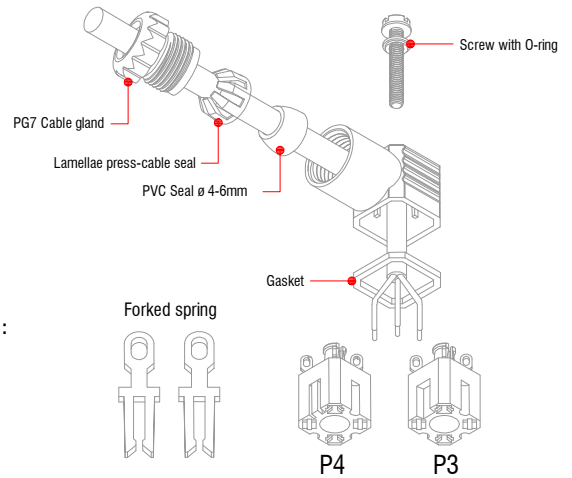

GENERAL FEATURES BASIS:

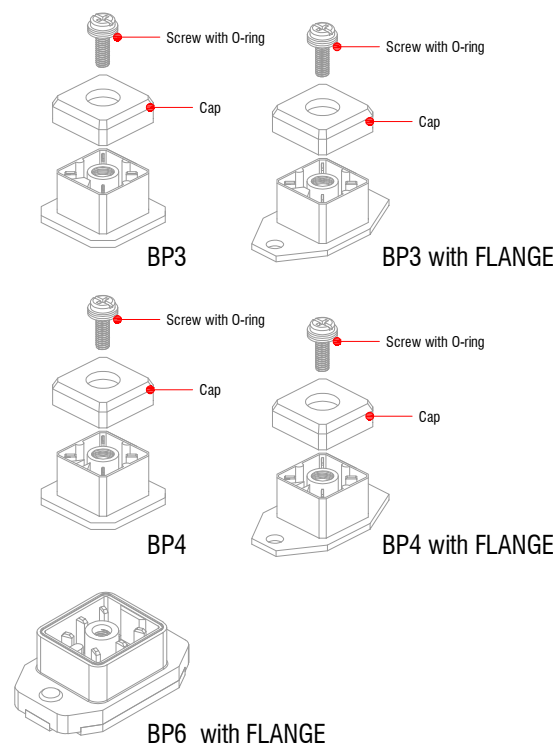
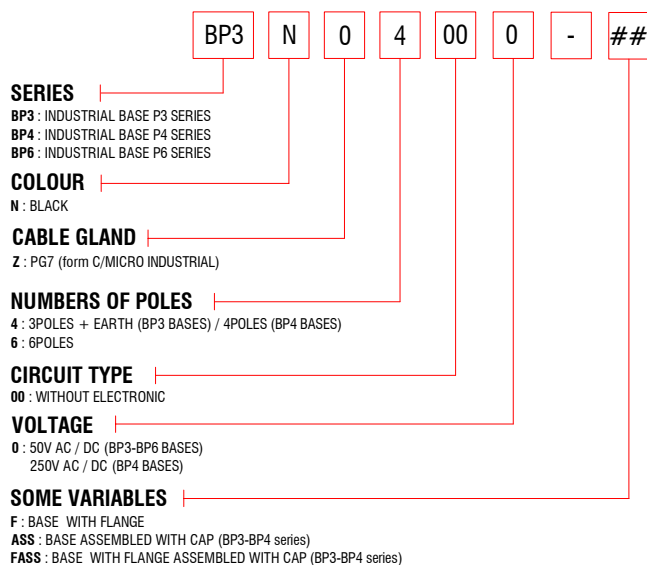

INDUSTRIAL CONNECTORS

IEC 61984 connectors - Field attachable connectors



Technical drawing			
Product description			
Connector type	Industrial connectors	Industrial connectors	Accessories
Conforms to	IEC 61984	IEC 61984	-
Construction type	-	-	-
Part number	P3NZ4000	P4NZ4000	BP3NZ4000-CAP
Description	Industrial connector 16X16mm P3 series complete with gasket and fixing screw. Connector without electronic.	Industrial connector 16X16mm P4 series complete with gasket and fixing screw. Connector without electronic.	Cap for basis BP3 and BP4 series complete with central fixing screw.
Number of contacts	4poles	3poles + P.E.	
Housing colour	Black	Black	Black
Height housing	15mm	15mm	
Cable gland	PG7	PG7	
Gasket type	NBR gasket	NBR gasket	NBR gasket
Technical data			
Type of termination	Solder contacts	Solder contacts	
Contact screw torque	-	-	
Rated voltage	50V AC/DC	250V AC/DC	
Rated current	6A	6A	
Circuit type	Without electronic	Without electronic	
Led colour	-	-	
Suitable cable	Ø cable 4-6mm	Ø cable 4-6mm	
Central fixing screw	M3 L=23mm	M3 L=23mm	
Central fixing screw material	Stainless steel AISI304	Stainless steel AISI304	Stainless steel AISI304
Central screw torque	0.5 N*m	0.5 N*m	
Packaging			
Qty/Box	50pcs / bag	50pcs / bag	50pcs / bag
Other accessories options			
See accessories section			
Notes:			
			CAP suitable for BP3/BP4 connectors.

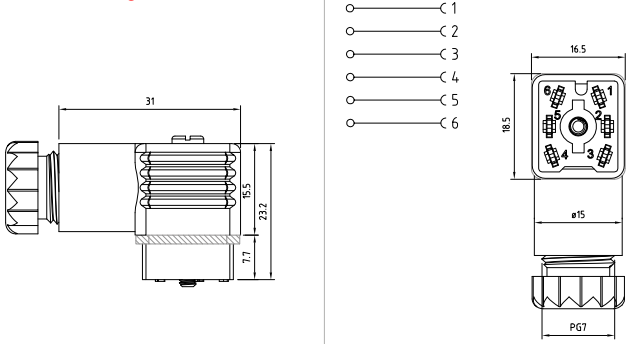
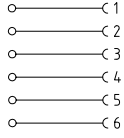

Technical drawing			
			
Product description			
Connector type	Industrial connectors		
Conforms to	IEC 61984		
Construction type	-		
Part number	P6NZ6000		
Description	Industrial connector 18.5X16.5mm P6 series complete with gasket and fixing screw. Connector without electronic.		
Number of contacts	6poles		
Housing colour	Black		
Height housing	15.5mm		
Cable gland	PG7		
Gasket type	NBR gasket		
Technical data			
Type of termination	Solder contacts		
Contact screw torque	-		
Rated voltage	50V AC/DC		
Rated current	6A		
Circuit type	Without electronic		
Led colour	-		
Suitable cable	∅ cable 4-6mm		
Central fixing screw	M3 L=23mm		
Central fixing screw material	Stainless steel AISI304		
Central screw torque	0.5 N*m		
Packaging			
Qty/Box	50pcs / bag		
Other accessories options			
See accessories section			
Notes:			

INDUSTRIAL CONNECTORS

IEC 61984 connectors - Field attachable connectors



Technical drawing				
Product description				
Connector type	Industrial base	Industrial base	Industrial base	Industrial base
Conforms to	IEC 61984	IEC 61984	IEC 61984	IEC 61984
Construction type	-	-	-	-
Part number	BP3N04000	BP3N04000-F	BP4N04000	BP4N04000-F
Description	Industrial base 16X16mm BP3 series complete with flat gasket.	Industrial base 16X16mm BP3 series with flange, complete with flat gasket.	Industrial base 16X16mm BP4 series complete with flat gasket.	Industrial base 16X16mm BP4 series with flange, complete with flat gasket.
Number of contacts	4poles	4poles	3poles + P.E.	3poles + P.E.
Base colour	Black	Black	Black	Black
Gasket type	-	Flat NBR gasket	-	Flat NBR gasket
Technical data				
Type of termination	Contacts to solder PCB	Contacts to solder PCB	Contacts to solder PCB	Contacts to solder PCB
Rated voltage	50V AC/DC	50V AC/DC	250V AC/DC	250V AC/DC
Rated current	6A	6A	6A	6A
Number of fixing holes	-	N°2	-	N°2
Diameter of fixing holes	-	ø3.2mm	-	ø3.2mm
Fixing holes distance	-	23mm	-	23mm
Central nut type	Closed	Closed	Closed	Closed
Packaging				
Qty/Box	400pcs / box	300pcs / box	400pcs / box	300pcs / box
Other accessories options				
See accessories section				
Notes:				
	BP3N04000-ASS: Base assembled with cup.	BP3N04000-FASS: Base assembled with cup.	BP4N04000-ASS: Base assembled with cup.	BP3N04000-FASS: Base assembled with cup.

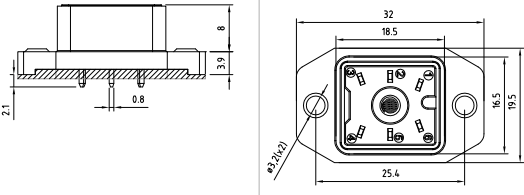
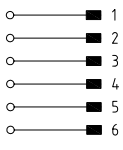

Technical drawing				
				
Product description				
Connector type	Industrial base			
Conforms to	IEC 61984			
Construction type	-			
Part number	BP6N04000-F			
Description	Industrial base 18.5X16.5mm BP3 series with flange, complete with flat gasket.			
Number of contacts	6poles			
Base colour	Black			
Gasket type	Flat NBR gasket			
Technical data				
Type of termination	Contacts to solder PCB			
Rated voltage	50V AC/DC			
Rated current	6A			
Number of fixing holes	N°2			
Diameter of fixing holes	ø3.2mm			
Fixing holes distance	25.4mm			
Central nut type	Closed			
Packaging				
Qty/Box	200pcs / box			
Other accessories options				
See accessories section				
Notes:				

INDUSTRIAL CONNECTORS

EN175000 (interchangeable with MIL-C-5015) -
Field attachable connectors



• GENERAL FEATURES FIELD ATTACHABLE CONNECTORS/ TO PANEL:

The technical data of the circular connectors series 15 is in conformity with EN175000.
Specific features of these connectors are solid construction and easy handling.
This series of connector is interchangeable with MIL-C-5015, shell size 14S connectors.
Mains fields of application are proportional valves and measurement, test and control.

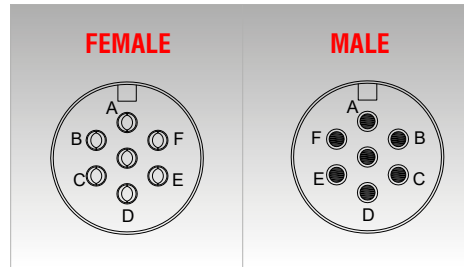

Cable Gland :
PG11 : \varnothing cable 6-10mm (field attachable).

Housing material :
PA66 UL94-V2 (field attachable).
Brass + Nickel plated (to panel).

Operating temperature :
-40°C +90°C.

Conductor cross section :
0.5mm²(20AWG)...1.5mm²(16AWG).

Coupling nut material:
Brass + Nickel plated.

Rated voltage:
~ 60V / ~ 75V.

Type of terminations :
Solder wires.

Internal core material :
PA66 UL94-V2.

Rated insulation voltage:
~ 150V.

Contact material and treatment :
Brass + gold flash.

Protection class :
IP65 (assembled).

Nominal current :
6A (0.5mm²).
9A (1.5mm²).

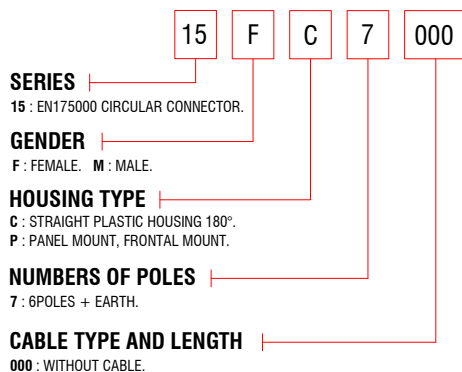

• 15MP7000

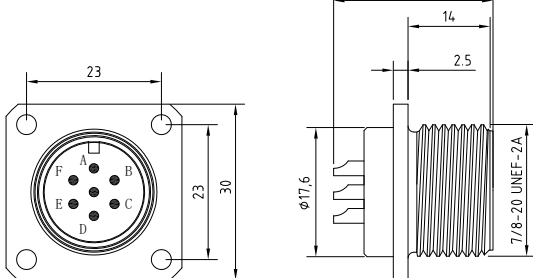

• 15FC7000

